



INNER REAL ESTATE NEXTRE



177 Adderley Street West Melbourne VIC

2 **1** **1**

Combining classic charm with contemporary style, this elegant home brings together the best of both worlds with its warming ambience and open plan layout that leads from inside to out for effortless entertaining. Set beneath high ceilings and enriched with polished floorboards, the home's design is easy to enjoy and ideal for professionals, young families or investors seeking a low-maintenance lifestyle. Ideally placed only moments from North Melbourne and Southern Cross stations, Queen Victoria Market, Flagstaff Gardens and Marvel Stadium.

? Two robed bedrooms, including one with a decorative fireplace

? Modern bathroom boasting a rainfall effect shower and floor-to-ceiling tiles

? Central kitchen adorned with gas stove, oven and dishwasher

Price : \$ 1,210,000

View : <https://www.innerrealestate.com.au/sale/vic/inner-city/west-melbourne/residential/house/7814419>

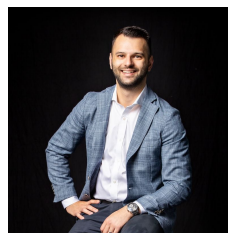

Anthony Cimino
+61 3 9804 5551

<https://www.innerrealestate.com.au>

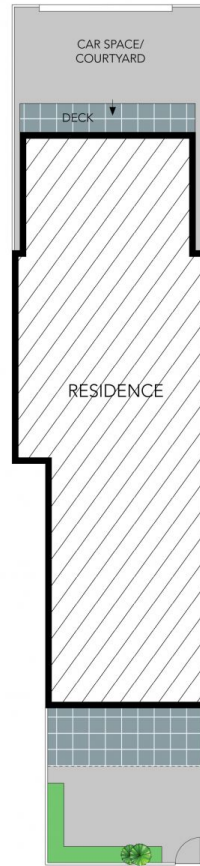

THIS PLAN IS NOT TO SCALE. MEASUREMENTS ARE INDICATIVE AND IN METRES. SITE PLAN REFLECTS APPROXIMATE POSITION OF BUILDINGS ON PROPERTY ONLY AND IS NOT AN ACCURATE REPRESENTATION OF VEGETATION AND OTHER EXTERNAL LANDSCAPE FEATURES. THIS PLAN SHOULD NOT BE RELIED UPON AND INTERESTED PARTIES SHOULD MAKE THEIR OWN ENQUIRIES.